

MOLDURA

Alfa-Gamma^{MR}

Installation as mold

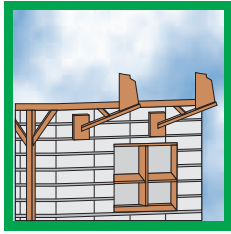

1 The formwork is installed in the traditional form of construction.

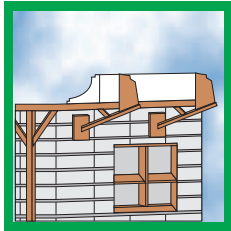

2 Once the formwork is set, the molding is placed watching that the alignment is set perfectly in the both sides.

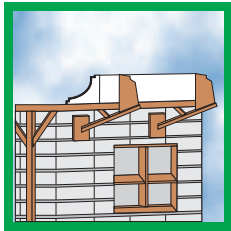

3 The molding is treated with burn oil to prevent that the concrete pouring sticks to the casting.



4 When carrying out casting, pay attention so the molding won't be moved during the concrete pouring.

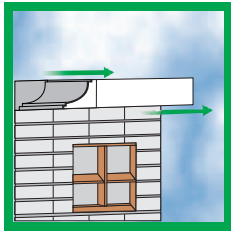

5 Once the concrete pouring and the hardening are completed, the formwork is removed and the molding is retired, leaving an economical, easy and fast way.

Direct Installation

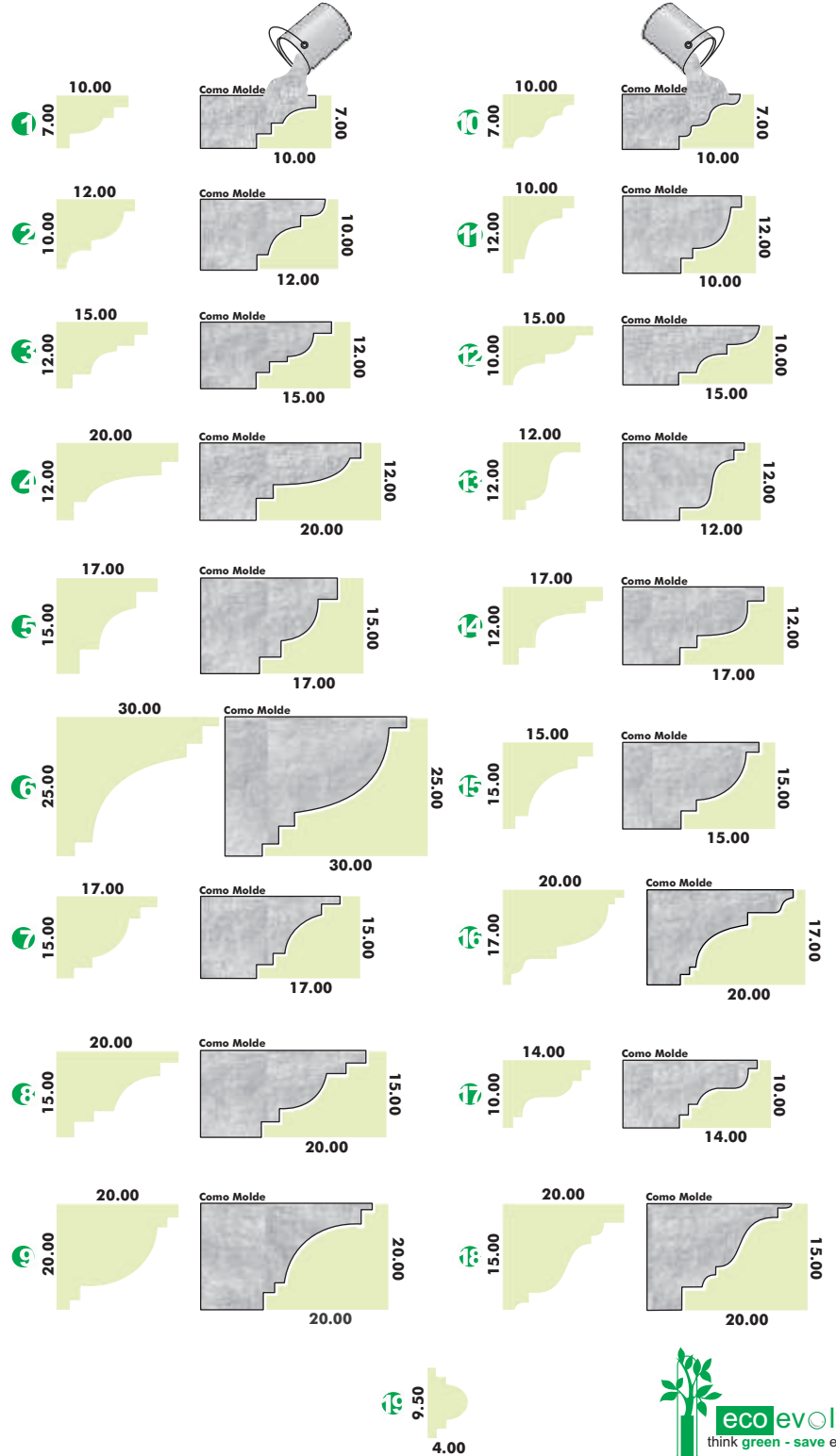
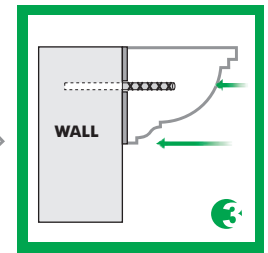
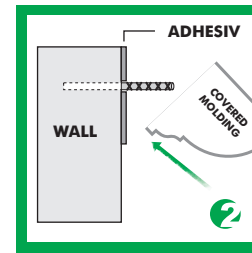
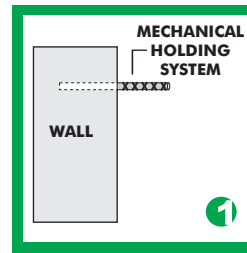

PLANTS

LAGUNA
(871) 759-09-50 al 53
g.sanchez@alfagamma.com.mx

JUÁREZ
(656) 687-35-60/61
m.soto@alfagamma.com.mx

TIJUANA
Líneas / México
(664) 623-51-91 / 92
Líneas / U.S.A.
(626) 334-53-58
(626) 777-19-01
a.acuna@alfagamma.com.mx

AGUASCALIENTES
(449) 910-64-60 al 69
m.rodriguez@alfagamma.com.mx

CULIACÁN
(667) 760-44-10/20
i.puente@alfagamma.com.mx

MONTERREY
(81) 8145-0608 / 09/10
j.navarro@alfagamma.com.mx

SALES OFFICES

SALTILLO
(871) 759-09-50 al 53
m.corral@alfagamma.com.mx

PUEBLA
(222) 281-07-93
263-13-11
263-28-19
p.martinez@alfagamma.com.mx

MÉXICO
(55) 5511-7828
(55) 5207-6891
h.labastida@alfagamma.com.mx

MAZATLÁN
(667) 760-44-10 / 20
l.osuna@alfagamma.com.mx

HERMOSILLO
(662) 118-01-39/40/41
c.hernandez@alfagamma.com.mx

GUADALAJARA
(449) 910-64-60 al 69
r.marquez@alfagamma.com.mx

DISTRIBUTION CENTER

HERMOSILLO
(662) 118-01-39/40/41
c.hernandez@alfagamma.com.mx



Technical advice
Type or services:

- a).- Structural plans
- b).- Sketch
- c).- Fast specifications of quantification of materials.
- d).- Memories of calculus.
- e).- Telephone customer service

