

Advantages and benefits of its use

Up to 10 to 30% savings in labor and formworks in comparison with the traditional building system used (solid slab, lighted slab with clay block, block, brick, etc.)

The thermal insulation is indispensable in extreme temperature zone due to its low thermal conductivity, providing comfort and electric energy saving in indoors refrigeration and heating.

The acoustic insulation diminishes external noise, offering more privacy and comfort in your home or office (absorbing up to 25 to 30 decibels depending on its placement.)

The versatility and resistance of its pieces allow them to adapt to any design calculus, minimizing the waste of materials.

Easy operation and fast installation

-The lightness and easy operation of its pieces permits to work with cleanliness because they can be held and stored easily.

-The easy installation of the Bovedilla Alfa-Gamma_{MR} allow you to save up to 50 or 60% in the falsework, which makes it ideal for the housing development projects.

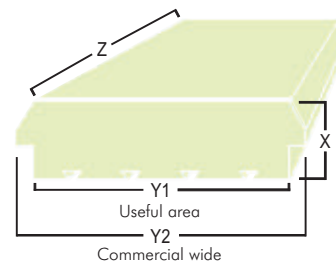

Units in cm.

X	Y2	Z
12 X	61 X	1.22
13 X	61 X	1.22
15 X	61 X	1.22
12 X	69 X	1.22
13 X	69 X	1.22
15 X	69 X	1.22

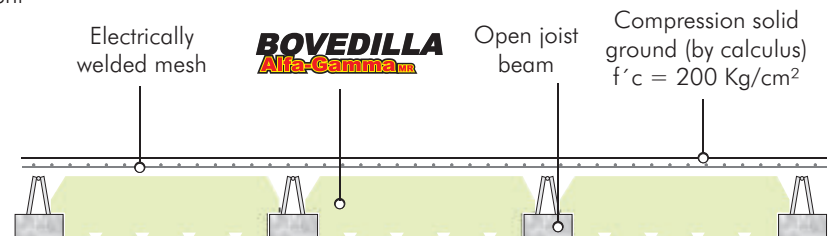

Technical specifications

- Compression layer over the top slab $f'c = 200 \text{ Kg/cm}^2$ and a thickness from 4 to 5 cm.
- The layer of compression is reinforced with an electrically welded 6x6 / 10 - 10 partially covering 10 cm.
- It is recommended to make a camber of 1.0 cm. per each 3 mts. of clearing in the center of the clearing.
- Maximum separation between timbers of 1.60 mts.
- Maximum separation between mainstay 1.00 mts.

Additional specification to the system

Distances between the axes of the beam	cm	68	68	76
Height of the top slab	cm	12	13	15
Thickness of the compression layer	cm	4	4	4
Inclination of the bank of the slabs	cm	16	17	19
Weight of the slabs	Kg/m ²	152	150	145
Amount of the concrete	Litros/m ²	50	52	54
Bovedilla of Poliestireno Alfa-Gamma _{MR}	m ² /m ²	1.1	1.1	1.1

Beam

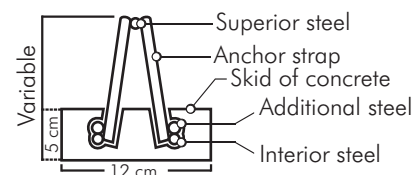

Characteristics of the beam

- Height of the skid: 5 cm
- Width of the skid: 12 cm
- Skid of concrete: $f'c = 200 \text{ Kg/cm}^2$
- Steel of the armature of the beam: $f_y = 6,000 \text{ Kg/cm}^2$
- Additional steel: (if necessary)



Technical advice
Type or services:

- Structural plans
- Sketch
- Fast specifications of quantification of materials.
- Memories of calculus.
- Telephone customer service

PLANTS
LAGUNA
(871) 759-09-50 al 53
g.sanchez@alfagamma.com.mx

TIJUANA
Líneas / México
(664) 623-51-91 / 92
Líneas / U.S.A.
(626) 334-53-58
(626) 777-19-01
a.acuna@alfagamma.com.mx

CULIACÁN
(667) 760-44-10/20
i.puente@alfagamma.com.mx

SALES OFFICES
SALTILLO
(871) 759-09-50 al 53
m.corral@alfagamma.com.mx

MÉXICO
(55) 5511-7828
(55) 5207-6891
h.labastida@alfagamma.com.mx

DISTRIBUTION CENTER
HERMOSILLO
(662) 118-01-39/40/41
c.hernandez@alfagamma.com.mx

JUÁREZ
(656) 687-35-60/61
m.soto@alfagamma.com.mx

AGUASCALIENTES
(449) 910-64-60 al 69
m.rodriguez@alfagamma.com.mx

MONTERREY
(81) 8145-0608 /09/10
j.navarro@alfagamma.com.mx

PUEBLA
(222) 281-07-93
263-13-11
263-28-19
p.martinez@alfagamma.com.mx

MAZATLÁN
(667) 760-44-10 / 20
l.osuna@alfagamma.com.mx

GUADALAJARA
(449) 910-64-60 al 69
r.marquez@alfagamma.com.mx